

MotorGuide® REPAIR PARTS

Model:
652

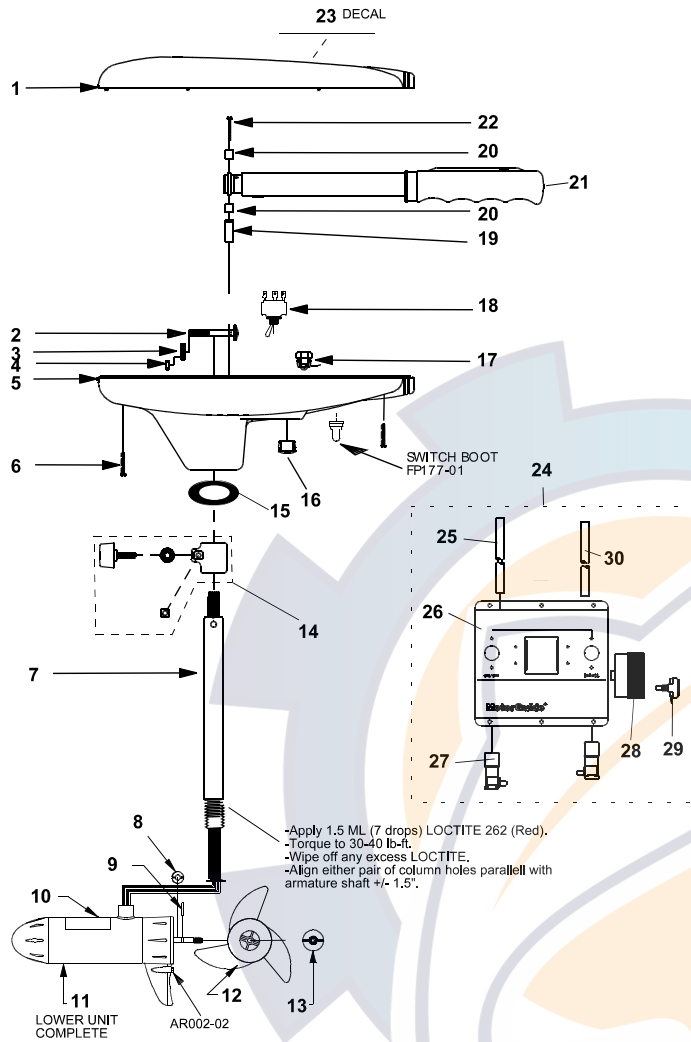

SPECIFICATIONS:

| | |
|----------|-------------|
| Year | 2000 |
| Thrust | 52LBS |
| Volts | 12VDC |
| Amp Draw | 0 to 48amps |
| Mount | 15 Bow |
| Speeds | 5 For/Rev |

PARTS ORDERING & TECH ASSISTANCE

Consumer Relations
Phone 918-831-6989
Fax 800-982-8093

RETURNING GOODS

Returned Goods must be accompanied with a Returned Goods Authorization. Contact MotorGuide Consumer Relations to obtain RGA.

| KEY | DESCRIPTION | PART # | KEY | DESCRIPTION | PART # |
|-----|-------------------------|----------|-----|-----------------------|----------|
| 1 | COVER WHITE | AT053-17 | 24 | HANDLE ASY | AR372-10 |
| | COVER BLACK | AT053-18 | 25 | 8 X 1-3/8 SCREW | AR133-01 |
| 2 | NOT APPLICABLE | | 26 | NOMENCLATURE | BR056-06 |
| 3 | BOLT | TT134-01 | 27 | DEPTH COLLAR ASY | AR158-01 |
| 4 | CURVED WASHER | TT171-04 | 28 | BATTERY CABLE | GP328-01 |
| 5 | NYLON LOCK NUT | XT098-02 | 29 | FOOT BOX COVER | GP353-02 |
| 6 | T/H BASE WHITE | AR004-13 | 30 | FOOT SWITCH | FP149-01 |
| | T/H BASE BLACK | AR004-14 | 31 | ROTARY DIAL | GP082-02 |
| 7 | SCREW #8 X 1" | LF141-04 | 32 | ROTARY SWITCH | HF150-01 |
| 8 | | | 33 | FOOT BOX ASY COMPLETE | GP300-01 |
| 9 | | | 34 | COLUMN SEAL | AT079-01 |
| 10 | | | | | |
| 11 | 42" .095 SS H/O COLUMN | FR049-15 | | | |
| 12 | MARINE LOWER UNIT DECAL | AF060-04 | | | |
| 13 | MONOFILAMENT WASHER | AR175-01 | | | |
| 14 | PROP DRIVE PIN | BR102-01 | | | |
| 15 | PROP/ 3 BLADE | AF124-10 | | | |
| 16 | PROP NUT | AR099-01 | | | |
| 17 | 5 SP MOTOR | BF397-03 | | | |
| 18 | | | | | |
| 19 | 1/2" HOLE PLUG | FP021-03 | | | |
| 20 | GROMMET | GR019-03 | | | |
| 21 | TOGGLE SWITCH | FP153-06 | | | |
| 22 | WIRE BRACKET | AT155-04 | | | |
| 23 | RETAINER CLAMP | AR036-01 | | | |

Model:
652

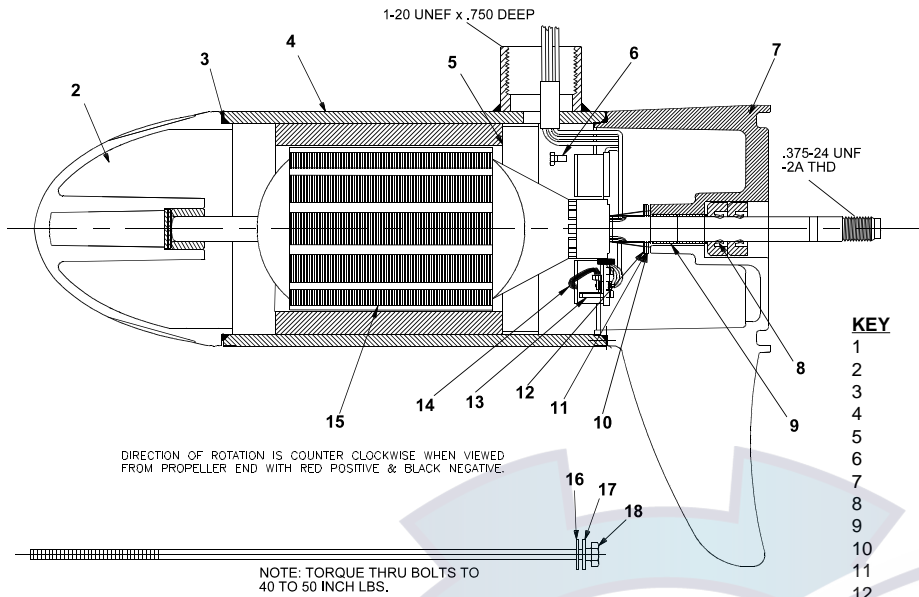

| KEY | QTY | DESCRIPTION | PART NO. |
|-----|-----|-----------------------|-----------|
| 1 | X | MOTOR | BF397-03 |
| 2 | 1 | NOSE CAP | JF3212-01 |
| 3 | 2 | O RING SEAL | MR217-01 |
| 4 | 1 | HOUSING ASY | JF3210-01 |
| 5 | 1 | RETAINER | JF233-01 |
| 6 | 2 | BRUSH CARD SCREW | MR228-01 |
| 7 | 1 | COMM CAP | BF3205-02 |
| 8 | 2 | SHAFT SEAL | MR223-01 |
| 9 | 1 | BEARING | MR206-01 |
| 10 | 1 | NYLATRON WASHER | MR226-01 |
| 11 | 1 | WASHER | MR227-01 |
| 12 | 1 | E RING | MR219-02 |
| 13 | 2 | BRUSH SPRINGS | MR214-02 |
| 14 | 1 | BRUSH ASY LESS SPRING | BF3201-02 |
| 15 | 1 | ARMATURE | JF3207-01 |
| 16 | 4 | STATIC SEAL | MR222-01 |
| 17 | 4 | THRU BOLT WASHER | MR216-01 |
| 18 | 2 | THRU BOLT | MR218-02 |

WIRING

12/24V WIRING DIAGRAM

FOOT PEDAL

MOTOR TOP HOUSING

12/24 SWITCH ON/OFF SWITCH
FP149-01

